

Shelf layouts are indicative only, and have been minimised for the sake of this presentation

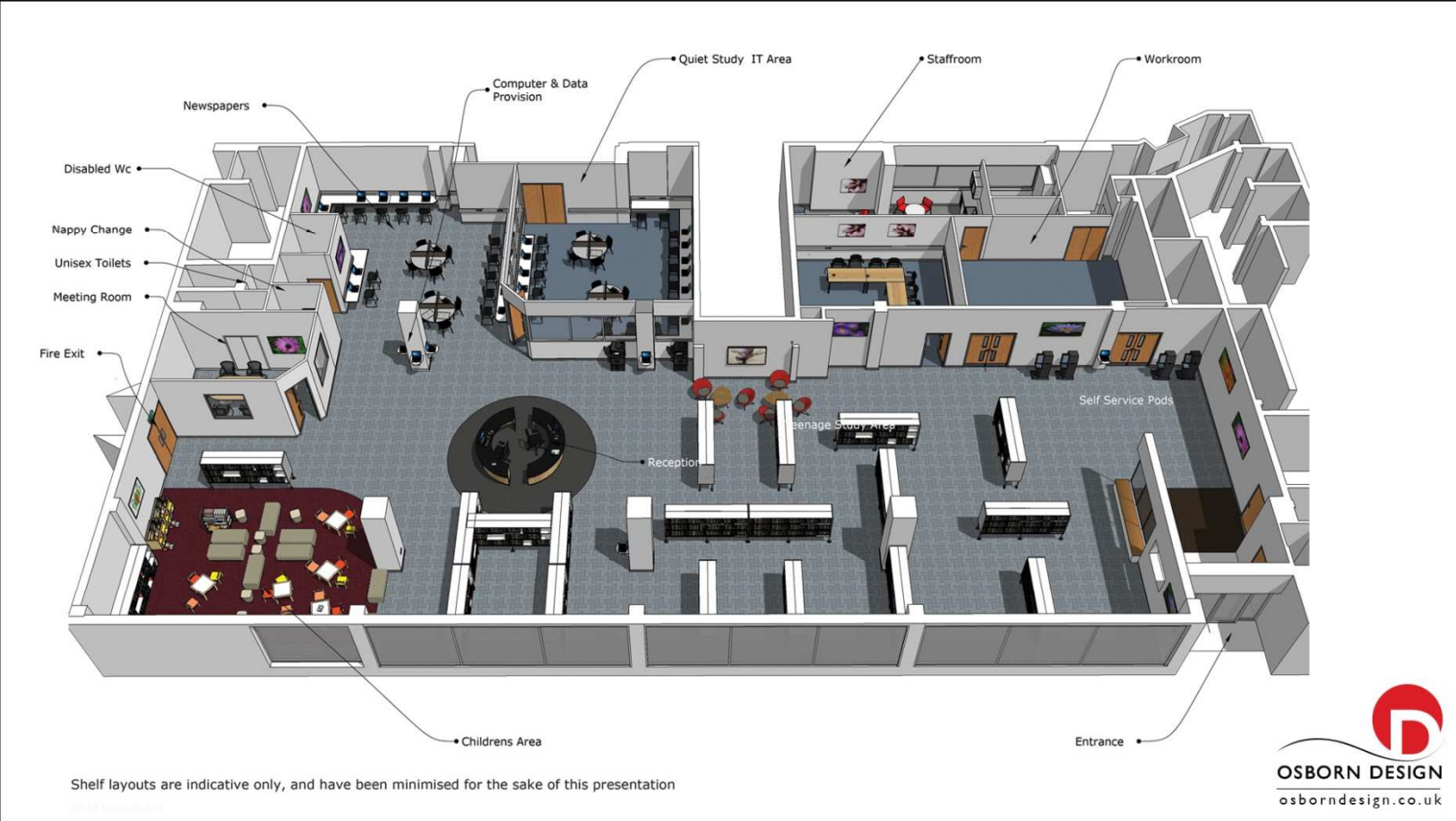



- On arrival showing glazing to left
- Staff pod and self service machine



OSBORN DESIGN  
osborndesign.co.uk

- Meeting room/classroom to right
- Student area
- New reception

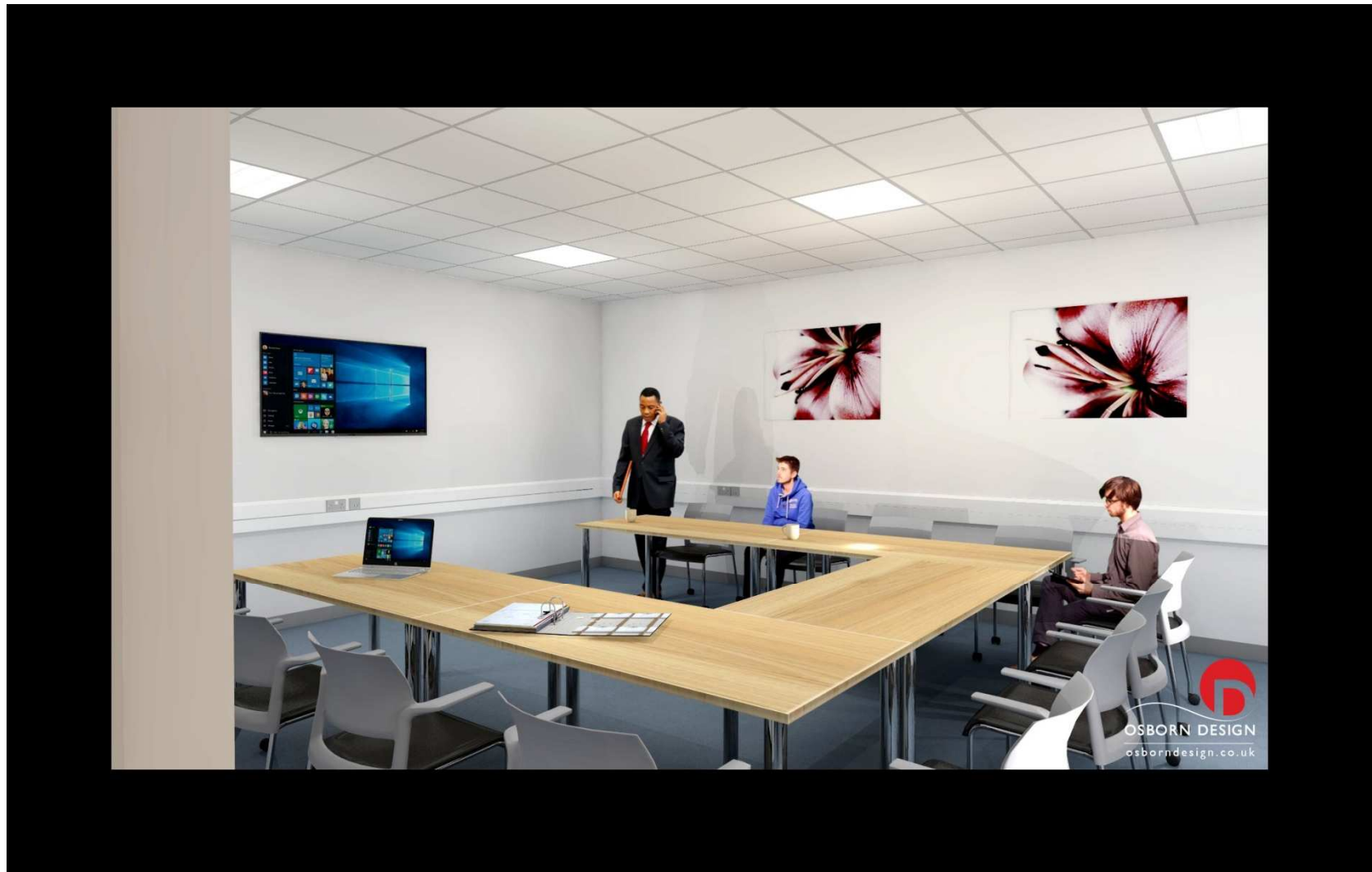

- Meeting room / classroom



- Main staff desk
- Study area
- Student area



- View out from study / quiet area





- Looking out from quiet / study area



- New WC's and nappy changing
- Study area - note laptop stations on columns
- Children's library at rear



- Student area near staff desk
- Staff pod and printing



- Children's area
- Staff desk / reception



- Children's library
- New meeting room / office
- Fire escape through double doors



- Children's library showing window frontage



**Shelving**

Castor offers you an efficient shelving system that is fully customisable to meet your individual needs and requirements and operates both in-store and online. A popular choice amongst libraries, this system complements both traditional and contemporary interiors while bringing a touch of style and class - G1 to G2



**Counters & IT/Study Space**

Modern Counter - F  
 Study Carrel - G3  
 Study Carrel - G4  
 Study Carrel - G5  
 Study Carrel - G6  
 Study Carrel - G7  
 Study Carrel - G8  
 Study Carrel - G9  
 Study Carrel - G10  
 Study Carrel - G11  
 Study Carrel - G12  
 Study Carrel - G13  
 Study Carrel - G14  
 Study Carrel - G15  
 Study Carrel - G16  
 Study Carrel - G17  
 Study Carrel - G18  
 Study Carrel - G19  
 Study Carrel - G20  
 Study Carrel - G21  
 Study Carrel - G22  
 Study Carrel - G23  
 Study Carrel - G24  
 Study Carrel - G25  
 Study Carrel - G26  
 Study Carrel - G27  
 Study Carrel - G28  
 Study Carrel - G29  
 Study Carrel - G30  
 Study Carrel - G31  
 Study Carrel - G32  
 Study Carrel - G33  
 Study Carrel - G34  
 Study Carrel - G35  
 Study Carrel - G36  
 Study Carrel - G37  
 Study Carrel - G38  
 Study Carrel - G39  
 Study Carrel - G40  
 Study Carrel - G41  
 Study Carrel - G42  
 Study Carrel - G43  
 Study Carrel - G44  
 Study Carrel - G45  
 Study Carrel - G46  
 Study Carrel - G47  
 Study Carrel - G48  
 Study Carrel - G49  
 Study Carrel - G50  
 Study Carrel - G51  
 Study Carrel - G52  
 Study Carrel - G53  
 Study Carrel - G54  
 Study Carrel - G55  
 Study Carrel - G56  
 Study Carrel - G57  
 Study Carrel - G58  
 Study Carrel - G59  
 Study Carrel - G60  
 Study Carrel - G61  
 Study Carrel - G62  
 Study Carrel - G63  
 Study Carrel - G64  
 Study Carrel - G65  
 Study Carrel - G66  
 Study Carrel - G67  
 Study Carrel - G68  
 Study Carrel - G69  
 Study Carrel - G70  
 Study Carrel - G71  
 Study Carrel - G72  
 Study Carrel - G73  
 Study Carrel - G74  
 Study Carrel - G75  
 Study Carrel - G76  
 Study Carrel - G77  
 Study Carrel - G78  
 Study Carrel - G79  
 Study Carrel - G80  
 Study Carrel - G81  
 Study Carrel - G82  
 Study Carrel - G83  
 Study Carrel - G84  
 Study Carrel - G85  
 Study Carrel - G86  
 Study Carrel - G87  
 Study Carrel - G88  
 Study Carrel - G89  
 Study Carrel - G90  
 Study Carrel - G91  
 Study Carrel - G92  
 Study Carrel - G93  
 Study Carrel - G94  
 Study Carrel - G95  
 Study Carrel - G96  
 Study Carrel - G97  
 Study Carrel - G98  
 Study Carrel - G99  
 Study Carrel - G100

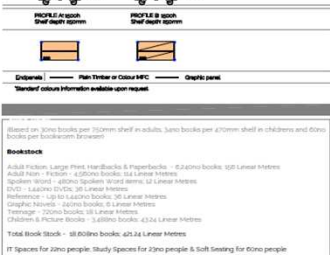
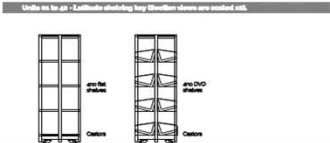

Unit 01 to 24 - 2.4m high shelving bay (includes shelves and castors)



Bookstock

Adult Fiction - Large Print, Hardback & Paperback - 62,400 books; 100 Linear Meters  
 Adult Non-Fiction - 42,000 books; 84 Linear Meters  
 Spoken Word - 48,000 Spoken Word items; 12 Linear Meters  
 DVD - 1,440,000 items; 28 Linear Meters  
 Reference - 1,440,000 books; 28 Linear Meters  
 Graphic Novel - 480,000 books; 96 Linear Meters  
 Teenage - 2,000 books; 40 Linear Meters  
 Children & Picture Books - 1,440,000 books; 28.8 Linear Meters  
 Total Book Stock - 18,000,000 books; 421.2 Linear Meters

IT Spaces for 200 people; Study Spaces for 200 people & Soft Seating for 600 people

Common fully upholstered operators chair - E2  
 W6 study chair - E5  
 Humba Tub Chair - F4  
 Calipso upholstered stool - H1 & H2  
 The Pearl sofa has a distinctive style and charm that will add a unique look to any breakout area - H3  
 Henley booth with acoustic qualities, to be used in teenage area - H5  
 Table to be used with Henley booth - G4  
 Elements display shelving - G1 & G2  
 45 degree stool to sit inbetween shelving bays - H5

Children Soft Seating & Collaboration

Tree Rug - G4  
 Bookarm browser complete with modular seats and browser units on castors - G1 & G2

Creating immediate 'Wow' in any space StoryWall is a magical oasis where children can engage in study times whilst enjoying inspirational surroundings. The StoryWall features a selection of modules especially designed to meet the display and storage needs of any library and learning space. In this particular design we have integrated shelving, seating with storage above with Story on side - H



Do Not Scale  
 Use Figure Dimensions Only. All dimensions to be checked on site.  
 Colours are for guidance only refer to samples for accurate representation.  
 © COPYRIGHT © FREM LTD

CLIENT: **AYLESBURY LIBRARY**  
 PROJECT: Library

TITLE: Proposed Library Design  
 DEALER:  
 CONTACT: DALLCOCK  
 DRAWN BY: C.DE FRATES  
 DATE: MARCH 17  
 REVISION:  
 SCALE: 1:75 @ A1  
 QUOTE NO: G29001  
 DRAWING NO: **0308D2L**

- Furniture concepts

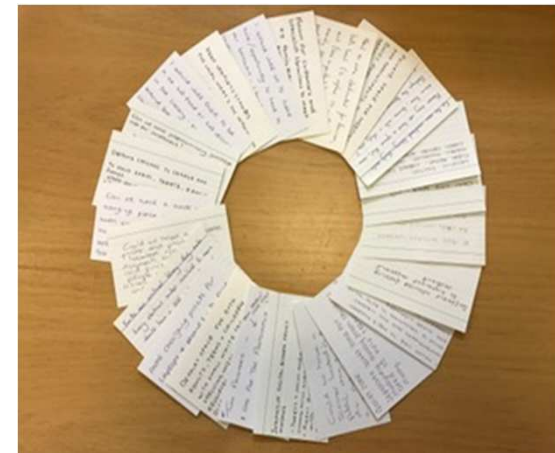
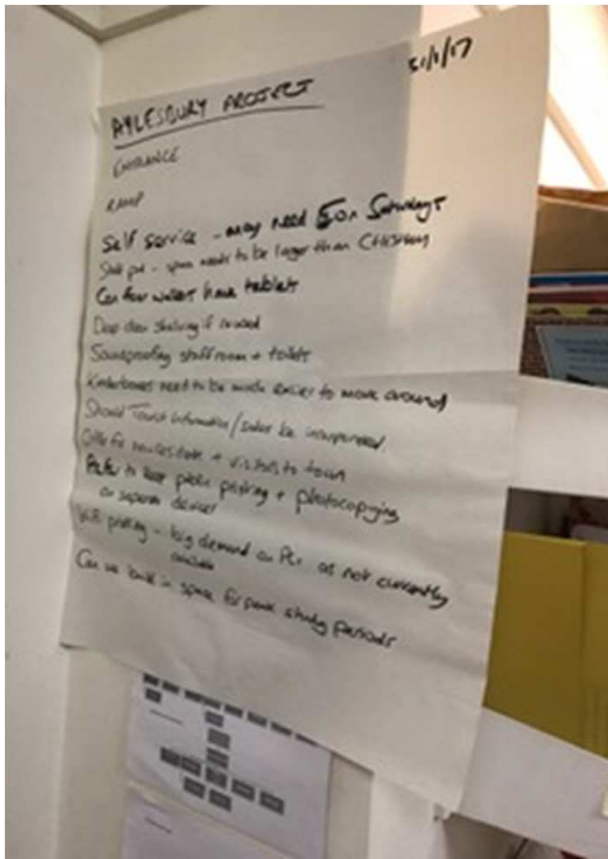

- Staff ideas



**Colour Scheme**

White carcass, Ambers, Grotto & Marmas  
JC Grape Vinyl

**PLAN VIEW**

**SEEN VIEW OF STORYWALL H**

**BACK VIEW OF STORYWALL H**

**FRONT VIEW OF STORYWALL H, SHOWING STORY TEXT**

Do Not Scale  
Use Figured Dimensions Only. All dimensions to be checked on site.  
Calculations for guidance only, refer to specification for accurate representation.  
COPYRIGHT © FREM LTD

Frem Ltd  
Concept House,  
Upton Valley Way East,  
Finesham Business Park,  
Northampton, NN4 9GF  
+44(0)1604 750507  
frem.co.uk

CLIENT: **AYLESBURY LIBRARY**

PROJECT: Library

TITLE: Proposed StoryWall®

DEALER:

CONTACT: DALLCOCK

DATE: MARCH 17

REVISION:

SCALE: 1:25 @ A1

QUOTE NO: Q29001

DRAWING NO: **0308D3R - 1**

Complete, inspired design solutions

- Children's play wall

# Ideas for external facia

